

Optical Fiber Distribution Box YY-H025

1. Description:

In the FTTX communication network system, it is used as the terminal point where the feeder cable is connected to the incoming cable. The product is used to connect optical fiber distribution cables to butterfly home optical cables through optical splitters, thus meeting the needs of users for high bandwidth bandwidth service openness. Fiber splicing, splitting, distribution can be done in this box, while providing solid protection and management for FTTX network construction.

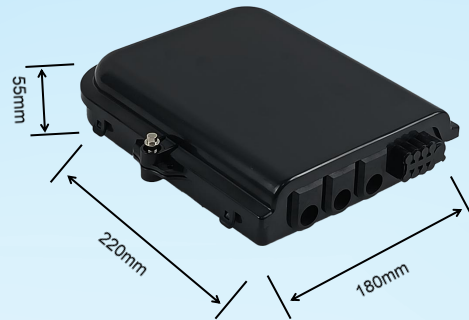

The fiber access end box can accommodate up to 8 subscriber splicing points as closure. It is used in FTTX network systems as an end point for splicing closure and feeder cable connections. It integrates fiber splicing, splitting, distribution, storage, and cable connections in a rugged protective box.

2. Features:

1. Water-proof design with IP-55 Protection Level.
2. Integrated with flap-up splice cassette and adaptor holder
3. All stainless metal plate and anti-rusting bolts, nuts
4. Fiber bend radius control more than 40mm
5. Suitable for the fusion splicer or mechanical splice
6. 1Pcs of 1*8 Splitter can be installed as an option
7. Mechanical sealing structure and mid-span cable entry.
8. 8 ports cable entrance for drop cable
9. 8 adapter for drop cable patching

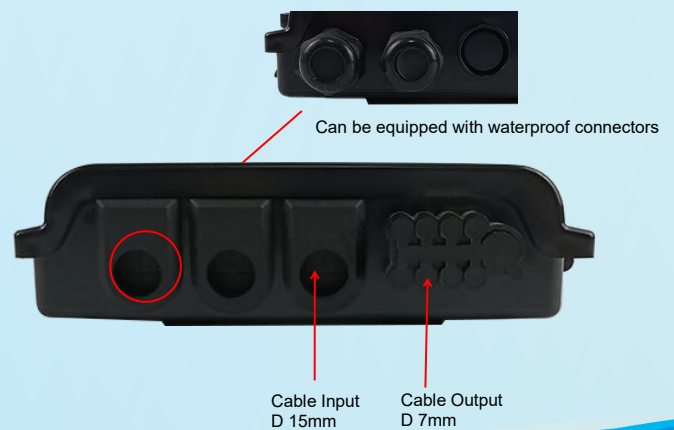
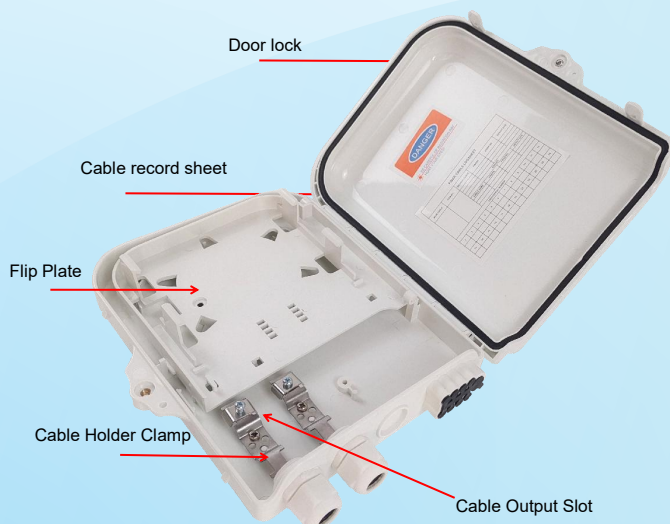

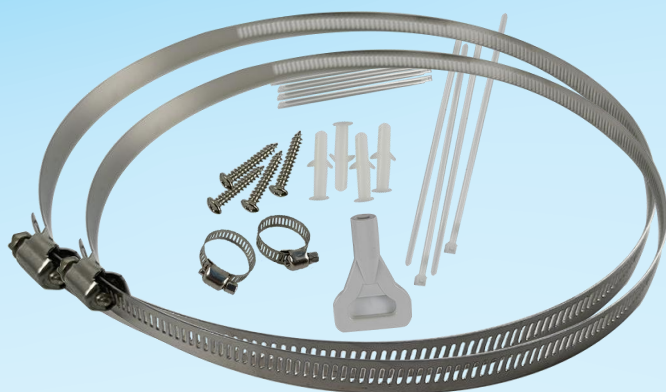

3. Specification:

Model	YY-H025
Core	SC/APC 8 core
Port	3 Inlet 8 Outlet
Material	ABS
Size	220*180**55mm
Single package size:	23x19x6 cm
Conventional packaging	52*30*42cm
Size of outer box with hoop	52*46*42cm
Package	bubble bag+box
weight	About 0.9kg
Warranty period	5-10 years
Network type	Wireless network, Bluetooth connection, wired network, GPRS, WIFI, 4G, GSM, 3G
Adapter (SC/APC)	8 piece waterproof adapter
PLC Splitter	1*8 Mini PLC Splitter
PLC Splitter Cassette	1*8SC-APC/UPC
Branch hole cable diameter (mm)	15 mm
Waterproof	IP55



4. Other attributes:

Color	White/Black
Logo	can be customized
Relative humidity	≤85% (+30℃)
Atmospheric pressure	70~106KPa
Temperature	-25℃~+45℃
Install	Wall mount/pole mount
Working environment	Indoor and outdoor

5. Product display:

